

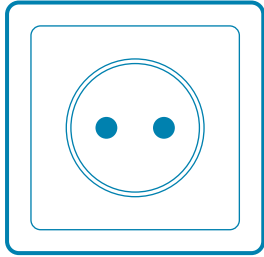

The Smartest Network Device

www.totolink.net



300Mbps Wireless N Range Extender

Model No. **EX200**



Up to 300Mbps
Wi-Fi speed



Smart Phone User
Interface Design



WPS



Two external antennas

➤ Overview

300Mbps Wireless N Range Extender

Model No. **EX200**

EX200 is a 2.4G wireless N range extender designed to expand the coverage of existing Wi-Fi network to eliminate "dead spots".

By pressing the WPS button on both EX200 and router in two minutes, Wi-Fi network could be extended quickly and easily.

With wall-plugging design, two high performance antennas, up to 300Mbps wireless N speed, EX200 can meet users' demands for wireless Internet access on hard-to-reach areas.

➤ Features

- Complies with 802.11b/g/n standards.
- Up to 300Mbps data rate for Wi-Fi network.
- Two external antennas enhance the throughput's stability.
- Portable and compact stylish design.
- Supports quick setting by smart phone.
- Supports WPS (Wi-Fi Protected Setup) Wi-Fi extension by one-click.
- One Ethernet port for connecting wired devices to wireless network.
- Energy saving and environmental protection.



Selling point

➤ Light Up Your Wi-Fi Everywhere

EX200 can extend your wireless network to every corner of your house, ensuring your mobile devices and PCs a reliable connection to the Internet.

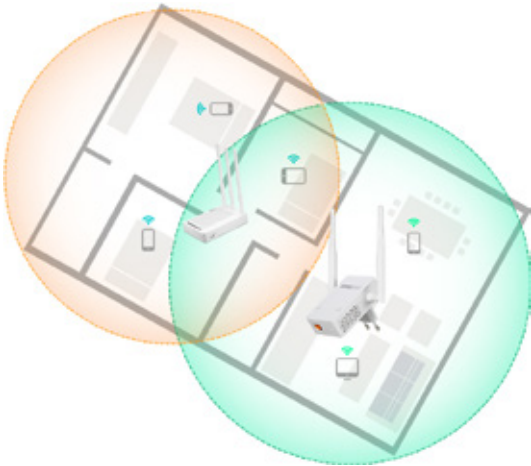

➤ 300Mbps Wireless N Speed

With two high performance antennas, EX200 delivers Wi-Fi speed up to 300Mbps, making Wi-Fi coverage more wider.

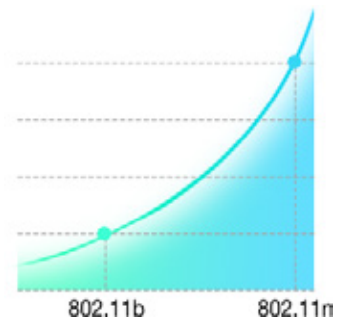

➤ One Click Wireless Secure Extension

Simply Press the WPS button on both EX200 and wireless router, secured home Wi-Fi network can be established quickly to extend the coverage of your existing WLAN network.

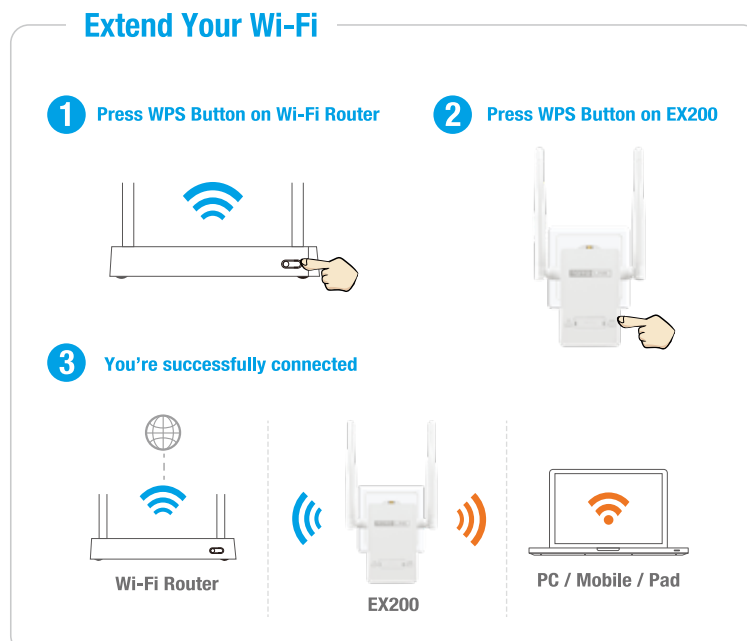

Specification

Hardware

Interface	- 1 * 10/100BaseTX (Auto MDI/MDIX) RJ45 port
Power Supply	- 5V/1A internal power
Antenna	- 2 * 4dBi External Antennas
Button	- 1 * WPS Button, 1 * RST Button
LED Indicator	- 1 * SYS, 1 * Wi-Fi
Dimensions (L X W X H)	- 52 x 85.7 x 30.9mm (not including antennas)

Wireless

Standards	- IEEE 802.11n, IEEE 802.11g, IEEE 802.11b
RF Frequency	- 2.4~2.4835GHz
Data Rate	- Up to 300Mbps
EIRP	- < 20dBm
Wireless security	- 64/128-bit WEP, WPA-PSK/WPA2-PSK (TKIP/AES)
Reception Sensitivity	- 11b 11M: - 81 dBm - 11g 54M: - 68 dBm - 11n HT20: - 65 dBm HT40: - 62 dBm

Others

Package Contents	- EX200 Wireless Extender *1 - Ethernet Cable *1 - Quick Installation Guide *1
Environment	- Operating Temperature: 0℃~50℃ (32℉~122℉) - Storage Temperature: -40℃~70℃ (-40℉~158℉) - Operating Humidity: 10%~90% non-condensing - Storage Humidity: 5%~90% non-condensing

ZIONCOM (HK) TECHNOLOGY LIMITED

Copyright©ZIONCOM (HK) TECHNOLOGY CO., LTD. All Rights Reserved.

Headquarter & R&D Center

7/F, Unit D, 4 Building Shenzhen Software Industry Base, Xuefu Road,
Nanshan District, Shenzhen, Guangdong, China

Tel : +86-755-6136-3288 (Ext.867) | FAX : +86-755-6136-3344

Factory

Building A1 & A2 Lantian Technology Park, Xinyu Road, Xinqiao Henggang Block,
Shajing Street, Baoan District, Shenzhen, Guangdong, China

Direct Line : +86-755-3686-1188(Ext. 5810) | FAX : +86-755-3686-1133

EX200

300Mbps Wireless N Range Extender