

# TOTO LINK

The Smartest Network Device

[www.totolink.net](http://www.totolink.net)



## CP450

### 400Mbps 5GHz Wireless Outdoor AP/Client



450Mbps  
802.11ac 5GHz



> 8KM  
Transferring  
Distance



IP65 Protection

**12**dbi  
ANTENNA

High-gain  
12dBi Antenna

## ➤ Overview

# 450Mbps 5GHz Wireless Outdoor AP/Client

### Model No. CP450

CP450 Wireless Outdoor CPE is specially designed for outdoor wireless transmission in villages, factories, parks, public squares and other outdoor areas.

With built-in high-gain polarized antennas and high RF output power configuration, CP450 supports point-to-point transmission, point-to-multipoint transmission and wide range outdoor wireless coverage. CP450 provides multiple working modes, which can be used in various outdoor situations. Meanwhile, CP450 supports Passive PoE power supply, enabling the installation and wiring more flexible in the outdoor. With professional protection design on shell, it is dust-proof, water-proof and lightning-proof, suitable for any kinds of severe climate, ideal for Wi-Fi transferring over long distance in the outdoor environment.

## ➤ Features

- Complied with the latest IEEE802.11ac standards, delivering 5G wireless speed up to 450Mbps.
- Built-in 12dBi high-gain polarized antennas, transmits wireless signal further and stronger.
- professional protection design on shell, suitable for any kinds of severe environment.
- IP65 level dust-proof and water-proof, 4KV lightning-proof and 15KV ESD static electricity-proof.
- Supports automatically pairing after getting power supply. (Double packed version)
- Supports Passive PoE power supply, transmitting distance can be far as 60 meters, more flexible for cabling deployment.
- Supports DC power supply, requiring no additional PoE equipment and reducing the installation cost.
- 4 intelligent LED indicators intuitively show signal strength.
- Provides AP/Client/Repeater/WISP working modes.



# Selling point

## ➤ 8km+ Wi-Fi Transmission

Complied with the latest IEEE802.11ac standards, CP450 supports to deliver wireless 5G speed up to 450Mbps, which will suffer less interference and be more competent for HD video and office working.

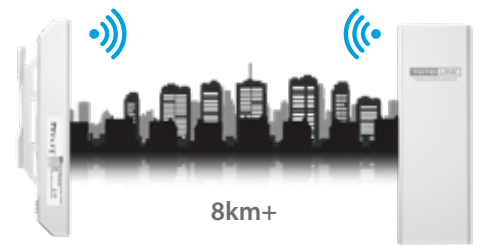

## ➤ High-gain Polarized Antennas

Built-in 12dBi high-gain polarized antennas, CP450 performs better in the Isolation and Diversity Reception of the wireless signal, delivering wireless signal much further and intensively, thus improving the Wi-Fi experience for the users.

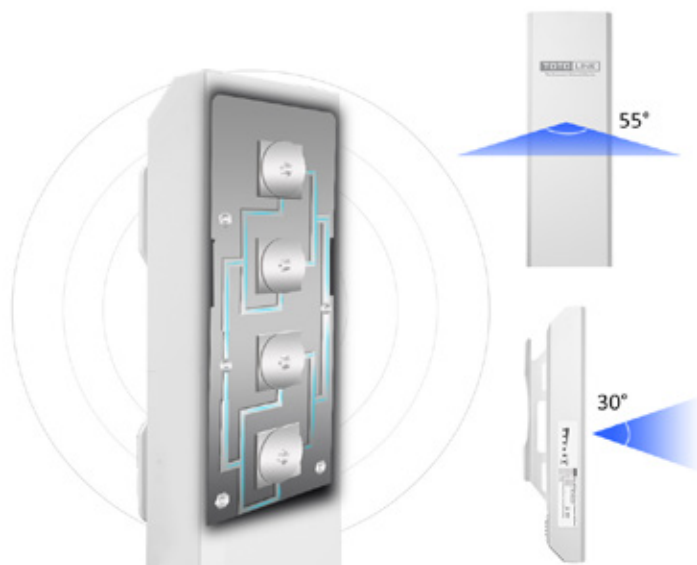

## ➤ Professional Protection Design on Shell

With professional structural design, CP900 supports IP65 level dustproof and waterproof, 4KV lighting proof and 15KV ESD that is resilient to all harsh environments.

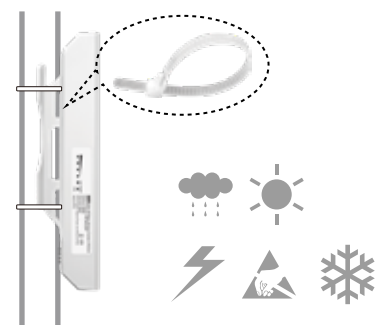

## ➤ Flexible Power Supply by Passive PoE

With Passive PoE power supply technology, CP450 conquers the difficulty of getting power supply in the outdoor environment. It supports to supply power for other devices over Ethernet, transmitting distance can be far as 60 meters, which improves the flexibility of cabling deployment in the outdoor environment.

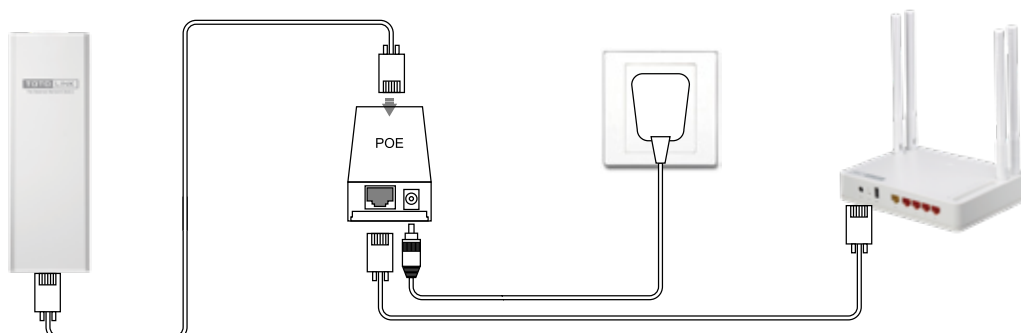

# Specification

## Hardware

Interface	- 1 *10/100Mbps Port (WAN/LAN, Passive PoE in) - 1 *10/100Mbps Port (LAN, Passive PoE in) - 1*Power Port
Power Supply	- 24V Passive PoE / 12VDC/2A - Voltage range: 12-24VDC
Button	- 1 *RESET Button
Antenna	- 1*Built-in 12dBi dual polarized antennas
LED Indicators	- 1 *MODE, 1 *Power, 1 *WAN/LAN, 1 *LAN, 4 *Signal Strength
Dimensions (L X W X H)	- 237.5 x 79 x 58.5mm

	
---	--

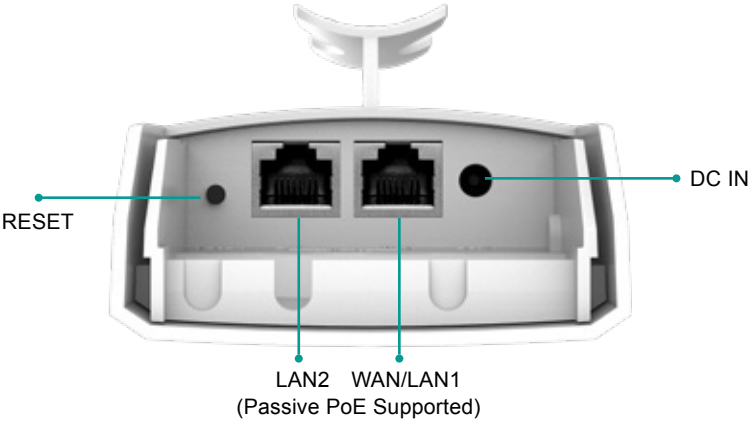
## Wireless

Standards	- IEEE 802.11n, IEEE 802.11g, IEEE 802.11b, IEEE 802.3, IEEE 8.3, IEEE 8.3ab, IEEE 8.3at
RF Frequency	- 5.15~5.825GHz
Data Rate	- Up to 450Mbps
EIRP	- < 23dBm
Wireless Security	- 64/128-bit WEP, WPA/WPA2, WPA-PSK/WPA2-PSK
Reception Sensitivity	- 11n(HT20): -68 dBm@10% PER - 11n(HT40): -65 dBm@10% PER - 11a: -72 dBm@10% PER - 11ac(VHT80): -55 dBm@10% PER

# Specification

## Software

Operation Mode	<ul style="list-style-type: none"><li>- AP Mode</li><li>- Repeater Mode</li><li>- Client Mode</li><li>- WISP Mode</li></ul>
MIMO Type	<ul style="list-style-type: none"><li>- 5G 1Tx-1Rx</li></ul>
Management	<ul style="list-style-type: none"><li>- Save/Reset Settings,</li><li>- Firmware upgrade,</li><li>- System Log</li></ul>
Reliability	<ul style="list-style-type: none"><li>- 4KV Lightning Protection</li><li>- 15KV ESD Protection</li><li>- IP65 level dustproof and waterproof</li></ul>

## Others

Package Contents	<ul style="list-style-type: none"><li>- CP450 Wireless CPE *1</li><li>- Power Adapter *1</li><li>- User Guide *1</li><li>- Ethernet Cable *1</li><li>- Strips*2</li></ul>
Environment	<ul style="list-style-type: none"><li>- Operating Temperature: -40℃~70℃ (-40℉~158℉)</li><li>- Storage Temperature: -40℃~70℃ (-40℉~158℉)</li><li>- Operating Humidity: 5%~95% non-condensing</li><li>- Storage Humidity: 5%~95% non-condensing</li></ul>

## ZIONCOM ( HK ) TECHNOLOGY LIMITED

Copyright©ZIONCOM (HK) TECHNOLOGY CO., LTD. All Rights Reserved.

### Headquarter & R&D Center

7/F, Unit D, 4 Building Shenzhen Software Industry Base, Xuefu Road,  
Nanshan District, Shenzhen, Guangdong, China

TEL : +86-755-3686-1138 | FAX : +86-755-3686-1139

### Factory

Building A1 & A2 Lantian Technology Park, Xinyu Road, Xinqiao Henggang Block,  
Shajing Street, Baoan District, Shenzhen, Guangdong, China

TEL : +86-755-3686-1188 | FAX : +86-755-3686-1133